



POWER CORPORATION OF CANADA STUDIO THEATRE INFORMATION PACKAGE

TABLE OF CONTENTS:

| | | |
|----------------------------|-------|-----------|
| Contact Information | _____ | 3 |
| Health & Safety | _____ | 4 |
| Room Information | _____ | 6 |
| Room Diagram | _____ | 7 |
| Lighting | _____ | 8 |
| Sound | _____ | 10 |
| Projection/AV | _____ | 11 |
| Soft Goods | _____ | 11 |
| Seating | _____ | 12 |
| Dressing Rooms | _____ | 13 |

CONTACT INFORMATION:

VENUE NAME Power Corporation of Canada Studio Theatre

VENUE ADDRESS Isabel bader Centre for the Performing Arts
390 King St. West, Kingston, ON, K7L 3N6

CONTACTS:

DAN School of Drama & Music

Main Office (613) 533-2066
Email info.danschool@queensu.ca
Website sdm.queensu.ca

| TITLE | NAME | CONTACT |
|---------------------------------|-------------------------------|----------------------------------------------------------------------------------------------------|
| Department Director | Julia Brook | (613) 513-2104 julia.brook@queensu.ca |
| Production Coordinator | Brian Frommer | (613) 561-6859 bf13@queensu.ca |
| Department Manager | Julia Stroud | (613) 533-2104 julia.stroud@queensu.ca |
| Head Carpenter/Shop Coordinator | Mark hunt | (613) 453-0496 mh52@queensu.ca |
| Wardrobe Coordinator | Marianna Thomlison | (613) 531-1033 marianna.thomlison@queensu.ca |
| Queen's Security | Emergency Report Line (24hrs) | (613) 533-6733 |
| Queen's Security | Dispatch | (613) 533-6111 |

SAFETY INFORMATION & GUIDELINES:

Queen's University is committed to the prevention of illness and injury through the provision and maintenance of a healthy and safe campus. The University endeavours to meet its responsibilities for the health and safety of the members of its community by complying with relevant health and safety standards and legislative requirements, and by assigning general and specific responsibilities for workplace health and safety.

The University takes all reasonable steps to acquaint its employees with their rights and duties in the workplace and applicable regulations and procedures for protecting their health and safety. Where appropriate, the University establishes policies and programs to assist in maintaining safe conditions and work practices and facilitating employee participation in health and safety activities, including health and safety committees.

All individuals shall protect their own health and safety by complying with prevailing regulations and standards and with safe practices and procedures established by the University. Employees must report any health hazards and unsafe conditions or practices to supervisory staff for corrective action.

It is a primary duty of all faculty and staff who are supervisors, as defined under the Occupational Health and Safety Act, to ensure that any persons under their direction are made aware of and comply with all applicable health and safety policies and procedures. They are responsible for ensuring that all aspects of the workplace, including teaching and research sites, are safe and that any risks, hazards, and safety violations drawn to their attention are investigated and corrected promptly.

INTENTION: To reduce the risk of injury to those working with the Centre, including Centre staff, stagehands, volunteers, Venue Licensees and their workers

POLICY: In accordance with Federal and Provincial regulations, the University and the Centre have adopted a series of Safe Work Practices. Those practices apply to everyone granted access to the Centre.

During setup and strike work calls the following personal protective equipment must be worn: (failure to comply may result in an eviction from the stage)

- A)** when there are workers on the scaffolds or lift, or risk of head injury, everyone working, supervising or visiting the stage must wear a CSA approved hard hat.
- B)** CSA approved footwear with safety toe caps, shank and with electrical shock resistance
- C)** long pants

D) When any work is being performed on an elevated work platform (Genie Lift) or scaffolding the worker shall wear and use a Personal Travel Restraint System with full body harness and attached to the designated anchor point on the platform. Operating instructions issued by the manufacturer shall be followed at all times. This includes the requirement that all outriggers must be fully deployed.

E) Flame effects are not defined as explosives under the Explosive Act. Flame effect devices will have to be approved for use by the Production Manager. Detailed information on the device will be requested and on-site testing may be requested. Fees may apply.

F) Without valid license and certification, the department of Drama and Music will not authorize the use of any pyrotechnics or flame effects.

G) All firearms, including replica firearms used at the Studio must be handled in accordance with Federal legislation and the Universities procedures for weapons on campus.

ROOM INFORMATION:

The Studio Theatre is a black box theatre.
There are doors located in all 4 corners.
Audience entrance is normally through the East Doors.
A minimum of TWO (2) exit doors must be clear at all times for fire regulations.
There are hallways around a 4 sides allowing complete access.

| | |
|--------------------------------------------------------------------------------------------------------------------------------------------------------------------------------------------------------------------------------------------------------------------------------------------------------------------------------------------------------------------------------------|---------------------------------------------------------------------------|
| | |
| ROOM SIZE: | 46'-4 1/4" x 39'-5" |
| SEATING CAPACITY: | 100 (See Seating for more details) |
| GRID HEIGHT | 17'-0" |
| GRID SPECS: | 5' x 5' Spacing 1 1/2" Schedule 40 pipe (black) |
| GRID CAPACITY: | 30lbs/linear ft. |
| GRID ADDITIONAL: | Curtain track 8" from wall on all four sides. |
| GRID ADDITIONAL: | 12 "Strong Points" are located above Grid. Capacity = 200lbs |
| STAGE FLOOR: | Sprung Floor. Masonite on Plywood on 2x4 sleepers on rubber pads. |
| STAGE FLOOR: | Colour: Flat Black. |
| STAGE FLOOR: | Floor can be nailed/screwed into. |
| | |
| LOADING DOOR: | Loading bay door: 7'-7"W x 7'-9"H |
| ACCESS TO LOADING DOCK: | 75 ' hallway. Single truck loading bay with dock leveler. Door 92" x 119" |
| ACCESS TO LOBBY: | 2 East doors lead to lobby. Shared with Concert hall. |
| ACCESS TO BACKSTAGE | Double doors in South wall, single doors in east and west wall |
| OTHER FEATURES: | |
| Unistrut tracks and 2x8s mounted to walls at 4', 8', 12'. There is a floor pocket located centre stage. The booth is at the EAST END. Can accommodate lighting, sound and SM. Tech Storage stores seating risers, tools and other production gear. Green Room/Kitchen had program sound & video, microwave, sink, fridge, couches. Folding tables & chairs available. | |

ROOM DIAGRAM:

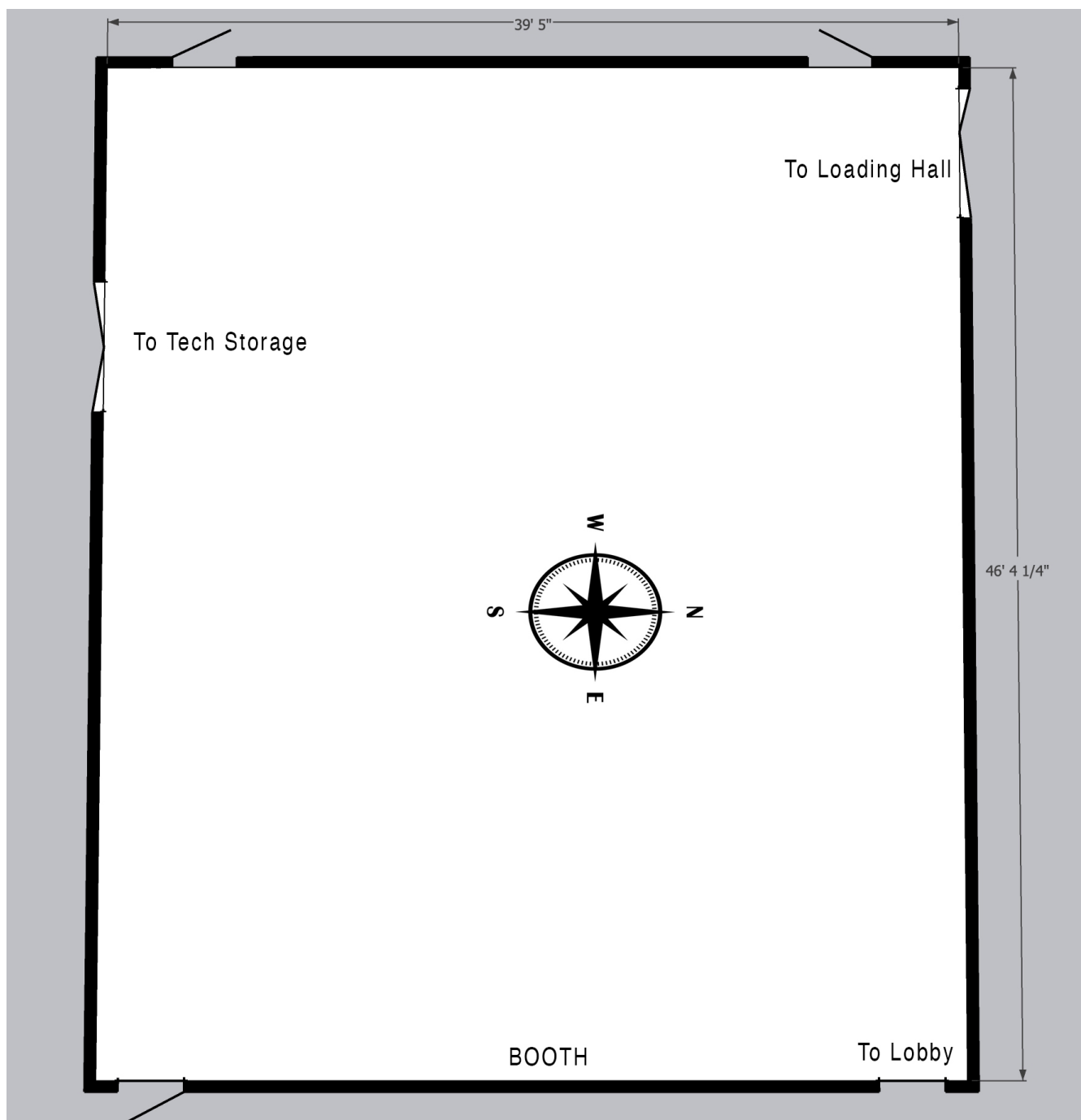

LIGHTING GRID:

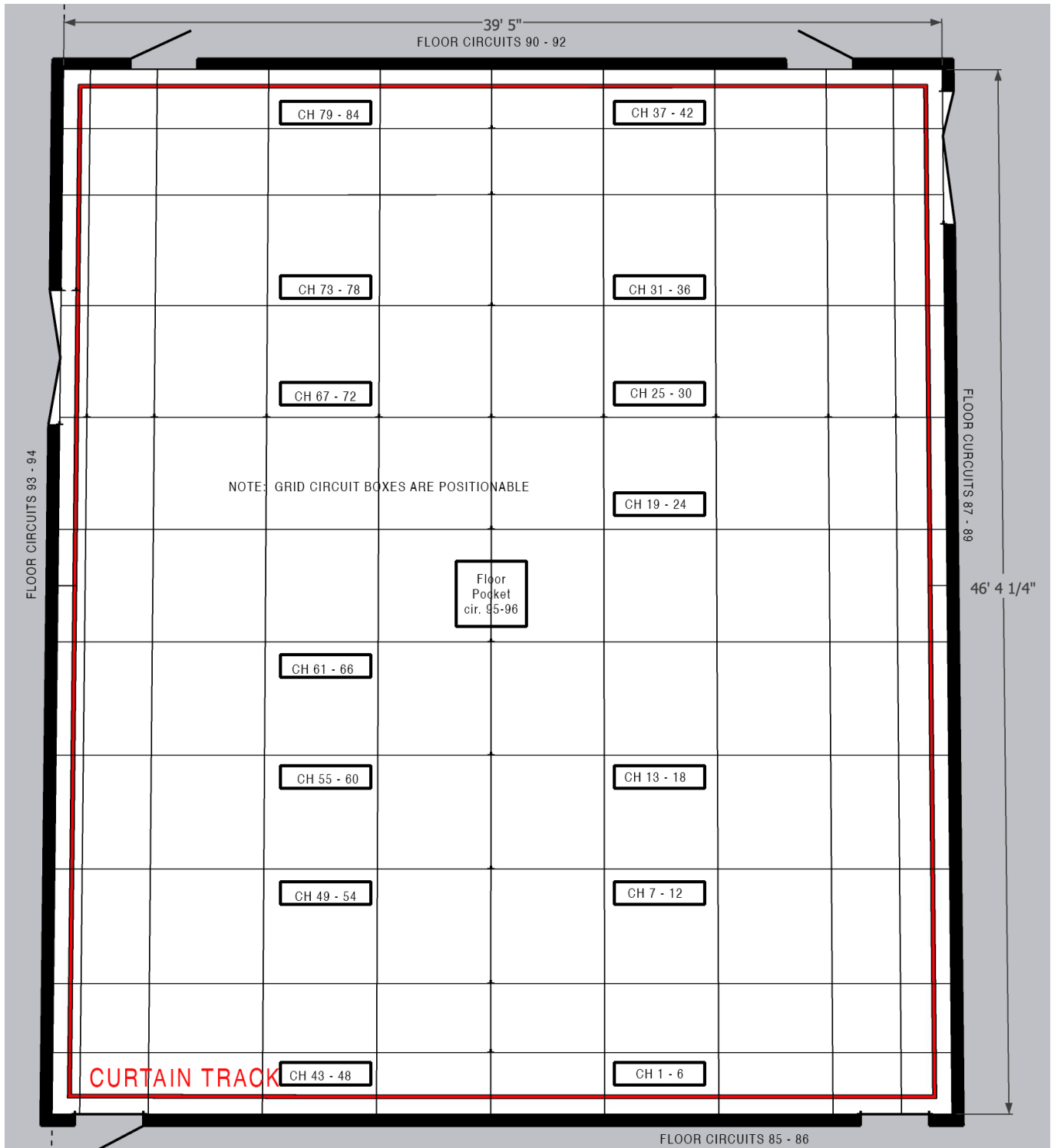

LIGHTING INVENTORY:

| ETC FIXTURES | | | OTHER | | |
|--------------|---------------------------------|----------------------|-------|-------------------------------------------|-------------------------------|
| 16 | Source4 Zoom 25-50 | | 1KW | 28 | Gobo Holders |
| | 16 | Top Hats | | 8 | Donuts, 7.5" |
| | 16 | Half Hats | | 10 | Donuts, 6" |
| 30 | Source4 36d | | 750W | 4 | Iris, manual |
| 25 | Source4 50d | | 750W | 2 | Scroller Power Supply |
| | 60 | Top Hats | | 20 | 12" Sidearms |
| | 60 | Half Hats | | 20 | 24" Sidearms |
| | 20 | Colour Extenders | | 3 | 12' Booms with Tie Offs |
| | 2 | 19d lenses | | | |
| | 2 | 26d lenses | | CABLE - Stage Lighting (Twistlock) | |
| | 2 | 36d lenses | | 50 | 2fers |
| | 2 | 50d lenses | | 30 | 5' cable |
| | 2 | Rosco ICue Units | | 20 | 10' cable |
| 20 | Source4 PAR 750 | | 750W | 10 | 25' cable |
| 18 | 6" FRESNELS | | 750W | 20 | 5' cable |
| | 20 | 4way Barn Doors | | | |
| | 20 | Top Hats | | DMX | |
| | 12 | Apollo MXR Scrollers | | 10 | 10' DMX 5Pin |
| 6 | Par38 Downlights (house lights) | | 90W | 5 | 25' DMX 5Pin |
| 36 | Selecon Hui CYC Lights | | 500W | 2 | 50' DMX 5Pin |
| 1 | ETC ION XE with 20Subs. | | | 12 | DMX Terminator |
| 96 | 2.4K Dimmer (1 per circuit) | | | 1 | DMX 5pin Male to male 12" |
| 2 | ETC Portable Network Nodes | | | 1 | DMX 5pin Female to female 12" |
| | | | | 16 | 10' Scroller 4pin |

SOUND INVENTORY:

| EQUIPMENT | BRAND | MODEL | NOTES |
|---------------------|------------------|-----------------|----------------------------------------------------------------------------------------------------------------|
| Mixer | Digico | SD 11 | 32 in, 12 out, 4FX |
| Interface | Digico | Digirack | In rack, 32 in, 8 out patchable |
| Loudspeakers | 4, QSC | K12.2 | Active, 2000W, hung in 4 corners |
| Loudspeakers | 4, Electro-voice | ELX115P | Powered, 1000W |
| Subs | 4, Electro-voice | ELX118P | Powered, 700W |
| Mics | 4, Shure | Beta58 | |
| Stands | 12, K&M | 6 tall, 6 short | +2 desk stands |
| Cables | Digiflex tour | 25' & 50' avail | |
| CD player | 1, Tascam | 200BT | |
| DVD/BluRay | 1, Denon | DBD3313 | |
| Booth Monitors | 2, Genelec | 8030B | |
| | | | |
| Wireless Mic System | | | |
| Receivers | 4, Sennheiser | EM500 | Rack mount |
| Transmitters | 4, Sennheiser | EW500 | Body Packs: SK500G3 |
| | 4, Sennheiser | | Plug on transmitters: SKP100G3 |
| Antenna Splitter | 1, Sennheiser | ASA1 | 2 Paddles available |
| Computer | Mac mini | | With QLab 4 (full) |
| | MacbookPro | A2485 | 10C CPU/24C GPU/64GB/2TB |
| Interface | 1, Madi | | 32 in / 32 out |
| Patch | | | Stage bosses are on all 4 walls at floor level and ceiling. 1 box centre stage in floor. 1 portable stage box. |

PROJECTIONS/AV:

| EQUIPMENT | BRAND | MODEL | NOTES |
|-----------|-----------|--------------|---------------------------------------|
| Projector | Panasonic | DZ680 | 6000 Lumens, dual lamp, mounting cage |
| Lenses | Panasonic | 1, standard | |
| | Panasonic | 1, ETDLE 350 | |
| | | 1, ETDLE 085 | |
| Projector | Panasonic | PT-MZ780BU | 7000 Lumens, Laser, mounting cage |
| Lenses | Panasonic | 1, standard | |
| | Panasonic | ETELU20 | 0.33:1 |
| Screen | Daylight | Fastfold | 8' H, 12' W, with 3' stand system |

SOFT GOODS:

| | | | |
|-----------------|--------------------------|-------------------------------------|--|
| 1 | White Cyc | 36' W, 16'9" H with grommets & pipe | |
| 1 | Black Scrim | 36' W, 16'9" H with grommets & pipe | |
| 2 | Black Borders | 36' W, 24" H, no fullness | |
| 6 | Legs | 8'3" W, 16'9" H, no fullness | |
| 3 | Tracked Traveler | 20' W, 16'9" H, no fullness | |
| | | | |
| NOTES | | | |
| Black curtains: | ENCORE Velour 220z., IFR | | |
| Scrim: | Black shark tooth | | |
| Cyc: | White cotton. | | |
| | | | |

SEATING SYSTEM:

| | | | |
|------------------------------------------------------------------------------|-----------------------|---------------------|------------------------|
| CHAIRS: | | | |
| 101, locking. Mix of arm & armless | | | |
| Maximum seating: 100. 1 chair for FOH usher | | | |
| Several configurations available. See CADD/Stage Drawings. | | | |
| NOTE: Max 8 chairs to an aisle. Max 15 to a row. Aisles must be 44" minimum. | | | |
| 3 1/2 seats per 2m deck. | | | |
| | | | |
| DECKS: | | | |
| 28 @ Staging concepts SC90 1m (39") x 2m (78") | | | |
| Black Plyron top | | | |
| | | | |
| RAILINGS: | CROSS BRACING: | LEGS: | FACIA BOARD: |
| Long Railings: 17 | Long: 4 | 7" (no label): 57 | Plain Black: 16 |
| Short Railings: 16 | Short: 6 | 14" (black): 57 | Glow Strip on Left: 6 |
| Railing Clamps: 18 | | 21" (yellow): 20 | Glow Strip on Right: 6 |
| | | 28" (green): 20 | |
| | | 35" (blue): 20 | |
| | | 42" (salmon): 20 | |
| | | Riser Leg Clamps: 7 | |
| | | | |

DRESSING ROOMS:

The Studio has two dressing rooms located behind the theatre space.

| ROOM # | CAPACITY | RACKS | CHAIRS | MIRRORS | SINKS | TOILETS | SHOWERS |
|--------|----------|-------|--------|---------|-------|---------|---------|
| 104B | 4-6 | 2 | 6 | 4 | 1 | 1 | 1 |
| 104C | 4-6 | 2 | 6 | 4 | 1 | 1 | 1 |
| | | | | | | | |

Extra capacity dressing rooms are located on 2nd floor and can be used if not otherwise booked.

| ROOM # | CAPACITY | RACKS | CHAIRS | MIRRORS | SINKS | TOILETS | SHOWERS |
|--------|----------|-------|--------|---------|-------|---------|---------|
| 210 | 10-27 | 2 | 12 | 16' | 6 | 5 | 1 |
| 211 | 10-27 | 2 | 12 | 20' | 6 | 5 | 1 |
| | | | | | | | |
| | | | | | | | |

NOTES:

Separate HVAC Control

Toilet & Shower located in adjacent room.

Quick change setup available upon request.

Minimum door size: 34" x 83"

Green room located behind Studio.

Kitchenette beside greenroom with sink, fridge, microwave.

WARDROBE WORK ROOM:

200sq ft room with work tables & chairs.

Wahers, dryer, iron, board, steamers.